

Modification of Standards for PUD

NO.	DESCRIPTION	STANDARD	PROPOSED MODIFICATION
1	REQUIREMENT THAT PUD BE SUBMITTED TO THE BOARD OF PUDS	SECTION 101.01	AMEND TO INCLUDE THE BOARD OF PUDS
2	REQUIREMENT THAT PUD BE SUBMITTED TO THE BOARD OF PUDS	SECTION 101.02	AMEND TO INCLUDE THE BOARD OF PUDS
3	REQUIREMENT THAT PUD BE SUBMITTED TO THE BOARD OF PUDS	SECTION 101.03	AMEND TO INCLUDE THE BOARD OF PUDS
4	REQUIREMENT THAT PUD BE SUBMITTED TO THE BOARD OF PUDS	SECTION 101.04	AMEND TO INCLUDE THE BOARD OF PUDS
5	REQUIREMENT THAT PUD BE SUBMITTED TO THE BOARD OF PUDS	SECTION 101.05	AMEND TO INCLUDE THE BOARD OF PUDS
6	REQUIREMENT THAT PUD BE SUBMITTED TO THE BOARD OF PUDS	SECTION 101.06	AMEND TO INCLUDE THE BOARD OF PUDS
7	REQUIREMENT THAT PUD BE SUBMITTED TO THE BOARD OF PUDS	SECTION 101.07	AMEND TO INCLUDE THE BOARD OF PUDS
8	REQUIREMENT THAT PUD BE SUBMITTED TO THE BOARD OF PUDS	SECTION 101.08	AMEND TO INCLUDE THE BOARD OF PUDS
9	REQUIREMENT THAT PUD BE SUBMITTED TO THE BOARD OF PUDS	SECTION 101.09	AMEND TO INCLUDE THE BOARD OF PUDS
10	REQUIREMENT THAT PUD BE SUBMITTED TO THE BOARD OF PUDS	SECTION 101.10	AMEND TO INCLUDE THE BOARD OF PUDS
11	REQUIREMENT THAT PUD BE SUBMITTED TO THE BOARD OF PUDS	SECTION 101.11	AMEND TO INCLUDE THE BOARD OF PUDS
12	REQUIREMENT THAT PUD BE SUBMITTED TO THE BOARD OF PUDS	SECTION 101.12	AMEND TO INCLUDE THE BOARD OF PUDS
13	REQUIREMENT THAT PUD BE SUBMITTED TO THE BOARD OF PUDS	SECTION 101.13	AMEND TO INCLUDE THE BOARD OF PUDS
14	REQUIREMENT THAT PUD BE SUBMITTED TO THE BOARD OF PUDS	SECTION 101.14	AMEND TO INCLUDE THE BOARD OF PUDS
15	REQUIREMENT THAT PUD BE SUBMITTED TO THE BOARD OF PUDS	SECTION 101.15	AMEND TO INCLUDE THE BOARD OF PUDS
16	REQUIREMENT THAT PUD BE SUBMITTED TO THE BOARD OF PUDS	SECTION 101.16	AMEND TO INCLUDE THE BOARD OF PUDS
17	REQUIREMENT THAT PUD BE SUBMITTED TO THE BOARD OF PUDS	SECTION 101.17	AMEND TO INCLUDE THE BOARD OF PUDS
18	REQUIREMENT THAT PUD BE SUBMITTED TO THE BOARD OF PUDS	SECTION 101.18	AMEND TO INCLUDE THE BOARD OF PUDS
19	REQUIREMENT THAT PUD BE SUBMITTED TO THE BOARD OF PUDS	SECTION 101.19	AMEND TO INCLUDE THE BOARD OF PUDS
20	REQUIREMENT THAT PUD BE SUBMITTED TO THE BOARD OF PUDS	SECTION 101.20	AMEND TO INCLUDE THE BOARD OF PUDS
21	REQUIREMENT THAT PUD BE SUBMITTED TO THE BOARD OF PUDS	SECTION 101.21	AMEND TO INCLUDE THE BOARD OF PUDS
22	REQUIREMENT THAT PUD BE SUBMITTED TO THE BOARD OF PUDS	SECTION 101.22	AMEND TO INCLUDE THE BOARD OF PUDS
23	REQUIREMENT THAT PUD BE SUBMITTED TO THE BOARD OF PUDS	SECTION 101.23	AMEND TO INCLUDE THE BOARD OF PUDS
24	REQUIREMENT THAT PUD BE SUBMITTED TO THE BOARD OF PUDS	SECTION 101.24	AMEND TO INCLUDE THE BOARD OF PUDS
25	REQUIREMENT THAT PUD BE SUBMITTED TO THE BOARD OF PUDS	SECTION 101.25	AMEND TO INCLUDE THE BOARD OF PUDS
26	REQUIREMENT THAT PUD BE SUBMITTED TO THE BOARD OF PUDS	SECTION 101.26	AMEND TO INCLUDE THE BOARD OF PUDS
27	REQUIREMENT THAT PUD BE SUBMITTED TO THE BOARD OF PUDS	SECTION 101.27	AMEND TO INCLUDE THE BOARD OF PUDS
28	REQUIREMENT THAT PUD BE SUBMITTED TO THE BOARD OF PUDS	SECTION 101.28	AMEND TO INCLUDE THE BOARD OF PUDS
29	REQUIREMENT THAT PUD BE SUBMITTED TO THE BOARD OF PUDS	SECTION 101.29	AMEND TO INCLUDE THE BOARD OF PUDS
30	REQUIREMENT THAT PUD BE SUBMITTED TO THE BOARD OF PUDS	SECTION 101.30	AMEND TO INCLUDE THE BOARD OF PUDS
31	REQUIREMENT THAT PUD BE SUBMITTED TO THE BOARD OF PUDS	SECTION 101.31	AMEND TO INCLUDE THE BOARD OF PUDS
32	REQUIREMENT THAT PUD BE SUBMITTED TO THE BOARD OF PUDS	SECTION 101.32	AMEND TO INCLUDE THE BOARD OF PUDS
33	REQUIREMENT THAT PUD BE SUBMITTED TO THE BOARD OF PUDS	SECTION 101.33	AMEND TO INCLUDE THE BOARD OF PUDS
34	REQUIREMENT THAT PUD BE SUBMITTED TO THE BOARD OF PUDS	SECTION 101.34	AMEND TO INCLUDE THE BOARD OF PUDS
35	REQUIREMENT THAT PUD BE SUBMITTED TO THE BOARD OF PUDS	SECTION 101.35	AMEND TO INCLUDE THE BOARD OF PUDS
36	REQUIREMENT THAT PUD BE SUBMITTED TO THE BOARD OF PUDS	SECTION 101.36	AMEND TO INCLUDE THE BOARD OF PUDS
37	REQUIREMENT THAT PUD BE SUBMITTED TO THE BOARD OF PUDS	SECTION 101.37	AMEND TO INCLUDE THE BOARD OF PUDS
38	REQUIREMENT THAT PUD BE SUBMITTED TO THE BOARD OF PUDS	SECTION 101.38	AMEND TO INCLUDE THE BOARD OF PUDS
39	REQUIREMENT THAT PUD BE SUBMITTED TO THE BOARD OF PUDS	SECTION 101.39	AMEND TO INCLUDE THE BOARD OF PUDS
40	REQUIREMENT THAT PUD BE SUBMITTED TO THE BOARD OF PUDS	SECTION 101.40	AMEND TO INCLUDE THE BOARD OF PUDS

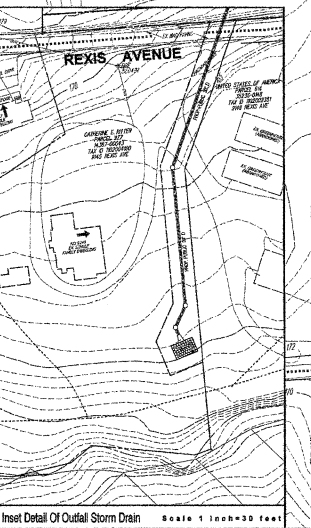

Inset Detail of Outfall Storm Drain Scale 1 inch=30 feet
Sheet 1002 of Continuation

OPEN SPACE PROPOSAL

OPEN SPACE TYPE	NO. ACRES	PERCENTAGE	PROPOSED ACRES	PERCENTAGE
Open Space Buffer	1.5	100%	1.5	100%
Open Space Core	0.0	0%	0.0	0%
Open Space Perimeter	0.0	0%	0.0	0%
TOTAL	1.5	100%	1.5	100%

SITE DATA AND DEVELOPMENT PROPOSAL

ZONE	APPROX. AREA (ACRES)	DEVELOPMENT TYPE	TOTAL DEVELOPMENT AREA (ACRES)	TOTAL DEVELOPMENT PERCENTAGE (%)	TOTAL DEVELOPMENT PERMITTED (%)
DA-100	1.00	Office	1.00	100%	100%
TOTAL	1.00	Office	1.00	100%	100%

ADDITIONAL INFORMATION

ANTICIPATED ACTIONS
 UNLESS OTHERWISE SPECIFIED, THE DEVELOPER SHALL...
 COMPLY WITH COUNTY ORDINANCES...
 CONDUCT WITH OTHER REGULATIONS...

COUNTY ADOPTED PLANS

PLANNING DISTRICT	ADOPTED PLAN	APPLICABILITY
K	K-1	ADDITIONAL
X	X-1	ADDITIONAL
X	X-2	ADDITIONAL
X	X-3	ADDITIONAL
X	X-4	ADDITIONAL

PUBLIC SCHOOL DISTRICT DATA AND ENROLLMENT PROJECTIONS

SCHOOL DISTRICT	NAME	ADDRESS	TYPE	ENROLLMENT (2024)	ENROLLMENT (2026)	ENROLLMENT (2028)	ENROLLMENT (2030)
1
2
3
4

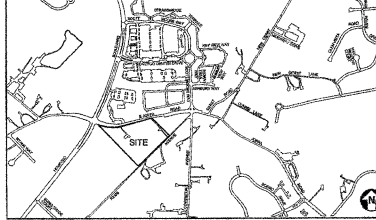

GENERAL DATA

- PROPERTY INFORMATION:
- 1.01 SITE LOCATION: ...
 - 1.02 ZONING: ...
 - 1.03 DEED RECORD: ...
 - 1.04 SURVEY: ...
 - 1.05 UTILITIES: ...
 - 1.06 ADJACENT PROPERTIES: ...
 - 1.07 LOCAL ORDINANCES: ...
 - 1.08 COUNTY ORDINANCES: ...
 - 1.09 STATE REGULATIONS: ...
 - 1.10 FEDERAL REGULATIONS: ...
 - 1.11 ENVIRONMENTAL REGULATIONS: ...
 - 1.12 HISTORIC LANDMARKS: ...
 - 1.13 CULTURAL RESOURCES: ...
 - 1.14 ARCHITECTURAL RESOURCES: ...
 - 1.15 HISTORIC DISTRICTS: ...
 - 1.16 LANDMARKS: ...
 - 1.17 PREVIOUS DEVELOPMENT: ...
 - 1.18 EXISTING UTILITIES: ...
 - 1.19 EXISTING ROADS: ...
 - 1.20 EXISTING PARKS: ...
 - 1.21 EXISTING OPEN SPACE: ...
 - 1.22 EXISTING WATERWAYS: ...
 - 1.23 EXISTING STRUCTURES: ...
 - 1.24 EXISTING INFRASTRUCTURE: ...
 - 1.25 EXISTING SERVICES: ...
 - 1.26 EXISTING EMPLOYMENT: ...
 - 1.27 EXISTING RECREATION: ...
 - 1.28 EXISTING CULTURAL: ...
 - 1.29 EXISTING HISTORIC: ...
 - 1.30 EXISTING ARCHITECTURAL: ...
 - 1.31 EXISTING LANDMARKS: ...
 - 1.32 EXISTING CULTURAL RESOURCES: ...
 - 1.33 EXISTING HISTORIC DISTRICTS: ...
 - 1.34 EXISTING LANDMARKS: ...
 - 1.35 EXISTING CULTURAL RESOURCES: ...
 - 1.36 EXISTING HISTORIC DISTRICTS: ...
 - 1.37 EXISTING LANDMARKS: ...
 - 1.38 EXISTING CULTURAL RESOURCES: ...
 - 1.39 EXISTING HISTORIC DISTRICTS: ...
 - 1.40 EXISTING LANDMARKS: ...
 - 1.41 EXISTING CULTURAL RESOURCES: ...
 - 1.42 EXISTING HISTORIC DISTRICTS: ...
 - 1.43 EXISTING LANDMARKS: ...
 - 1.44 EXISTING CULTURAL RESOURCES: ...
 - 1.45 EXISTING HISTORIC DISTRICTS: ...
 - 1.46 EXISTING LANDMARKS: ...
 - 1.47 EXISTING CULTURAL RESOURCES: ...
 - 1.48 EXISTING HISTORIC DISTRICTS: ...
 - 1.49 EXISTING LANDMARKS: ...
 - 1.50 EXISTING CULTURAL RESOURCES: ...
 - 1.51 EXISTING HISTORIC DISTRICTS: ...
 - 1.52 EXISTING LANDMARKS: ...
 - 1.53 EXISTING CULTURAL RESOURCES: ...
 - 1.54 EXISTING HISTORIC DISTRICTS: ...
 - 1.55 EXISTING LANDMARKS: ...
 - 1.56 EXISTING CULTURAL RESOURCES: ...
 - 1.57 EXISTING HISTORIC DISTRICTS: ...
 - 1.58 EXISTING LANDMARKS: ...
 - 1.59 EXISTING CULTURAL RESOURCES: ...
 - 1.60 EXISTING HISTORIC DISTRICTS: ...
 - 1.61 EXISTING LANDMARKS: ...
 - 1.62 EXISTING CULTURAL RESOURCES: ...
 - 1.63 EXISTING HISTORIC DISTRICTS: ...
 - 1.64 EXISTING LANDMARKS: ...
 - 1.65 EXISTING CULTURAL RESOURCES: ...
 - 1.66 EXISTING HISTORIC DISTRICTS: ...
 - 1.67 EXISTING LANDMARKS: ...
 - 1.68 EXISTING CULTURAL RESOURCES: ...
 - 1.69 EXISTING HISTORIC DISTRICTS: ...
 - 1.70 EXISTING LANDMARKS: ...
 - 1.71 EXISTING CULTURAL RESOURCES: ...
 - 1.72 EXISTING HISTORIC DISTRICTS: ...
 - 1.73 EXISTING LANDMARKS: ...
 - 1.74 EXISTING CULTURAL RESOURCES: ...
 - 1.75 EXISTING HISTORIC DISTRICTS: ...
 - 1.76 EXISTING LANDMARKS: ...
 - 1.77 EXISTING CULTURAL RESOURCES: ...
 - 1.78 EXISTING HISTORIC DISTRICTS: ...
 - 1.79 EXISTING LANDMARKS: ...
 - 1.80 EXISTING CULTURAL RESOURCES: ...
 - 1.81 EXISTING HISTORIC DISTRICTS: ...
 - 1.82 EXISTING LANDMARKS: ...
 - 1.83 EXISTING CULTURAL RESOURCES: ...
 - 1.84 EXISTING HISTORIC DISTRICTS: ...
 - 1.85 EXISTING LANDMARKS: ...
 - 1.86 EXISTING CULTURAL RESOURCES: ...
 - 1.87 EXISTING HISTORIC DISTRICTS: ...
 - 1.88 EXISTING LANDMARKS: ...
 - 1.89 EXISTING CULTURAL RESOURCES: ...
 - 1.90 EXISTING HISTORIC DISTRICTS: ...
 - 1.91 EXISTING LANDMARKS: ...
 - 1.92 EXISTING CULTURAL RESOURCES: ...
 - 1.93 EXISTING HISTORIC DISTRICTS: ...
 - 1.94 EXISTING LANDMARKS: ...
 - 1.95 EXISTING CULTURAL RESOURCES: ...
 - 1.96 EXISTING HISTORIC DISTRICTS: ...
 - 1.97 EXISTING LANDMARKS: ...
 - 1.98 EXISTING CULTURAL RESOURCES: ...
 - 1.99 EXISTING HISTORIC DISTRICTS: ...
 - 2.00 EXISTING LANDMARKS: ...

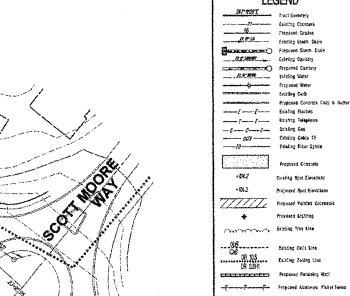

Preparer of Plan
 Matt Wolf, Maryland PLS
 21328 Perry Hall, Maryland 21078
 Phone: 410-253-7004
 Fax: 410-253-7006

Developer / Contract Purchaser
 Strawbridge Commons, LLC
 10000 York Road, Suite 100
 Hanover, Maryland 21076
 Phone: 410-253-7004
 Fax: 410-253-7006

Legal Owner
 PERRY HALL VILLAGE
 21328 Perry Hall, Maryland 21078

Concept Plan Site Proposal Map
Strawbridge Commons PUD
 AT THE VILLAGE OF HONEYGO
 Formerly Town of Honeygo
 NO. 5221 EAST JOPPA ROAD
 TAX MAP #2 PARCEL 07
 ELECTION DISTRICT NO. 11
 COUNCILMANIC DISTRICT 5
 PERRY HALL - BALTIMORE COUNTY, MARYLAND
 PLAN NO. 11-1133
 Plan Scale 1 Inch = 30 feet Sheet 2 of 2